

RayWhite[®]

TOUMA TAYLOR



Idyllic Family Sanctuary in a Highly Sought-after Cul-de-sac

11 Lancaster Crescent, Kingsford

4 bed 3 bath 1 car

Sold

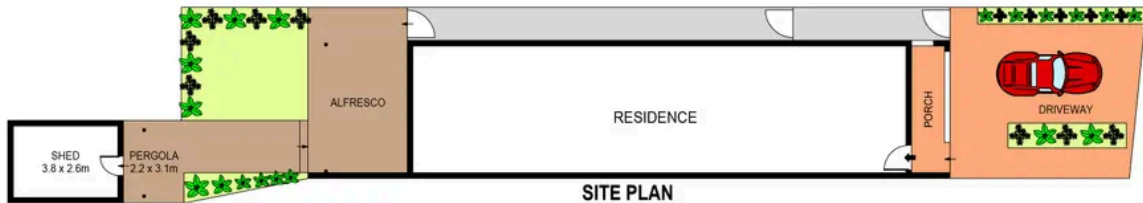

SITE PLAN
(NOT TO SCALE)



FIRST FLOOR

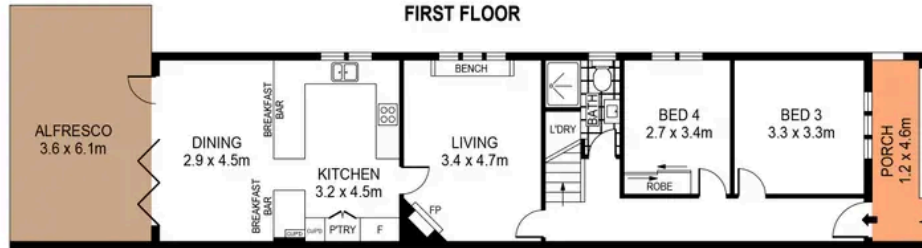

GROUND FLOOR



SCALE (METRES)

PLANS SHOWN ONLY INDICATIVE OF LAYOUT. DIMENSIONS ARE APPROXIMATE.
Ref. No: 01387

APPROX. INTERNAL AREA : 154m²
TOTAL LAND SIZE : 234m²



11 LANCASTER CRESCENT

KINGSFORD

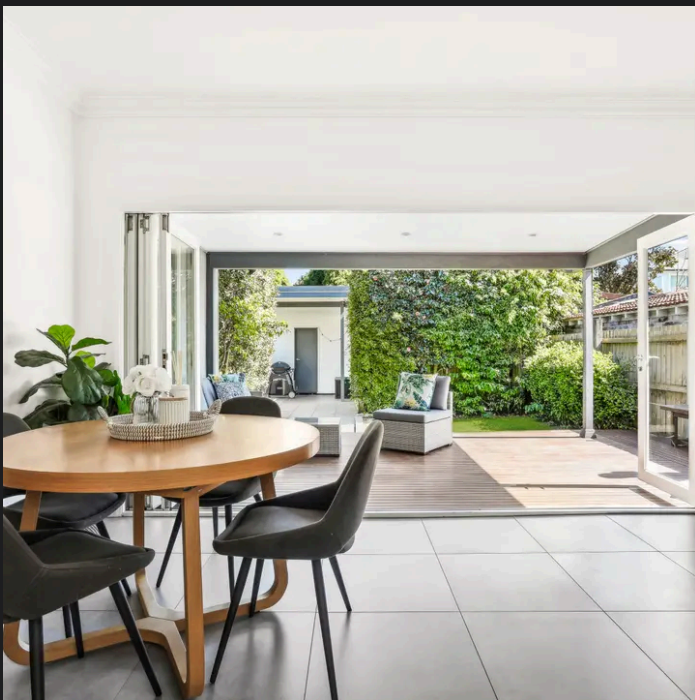

Roger Wardy 0481 355 493
roger.wardy@raywhite.com

Jesse Petersen 0404197940
jesse.petersen@raywhite.com

Disclaimer: All information provided is sourced from what we believe to be reliable sources. However, we do not guarantee its accuracy, and interested parties should conduct their own enquiries. Scale in metres. Indicative only. Dimensions are approximate.