

RayWhite®

TOUMA TAYLOR



Elevated City Fringe Living

114/13 Waine Street, Surry Hills

1 bath 1 car

Sold

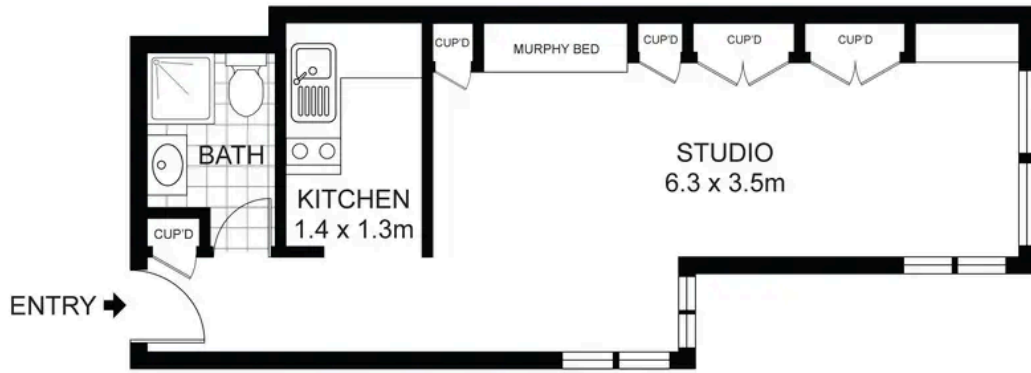

LEVEL ELEVEN



STORAGE CAGE

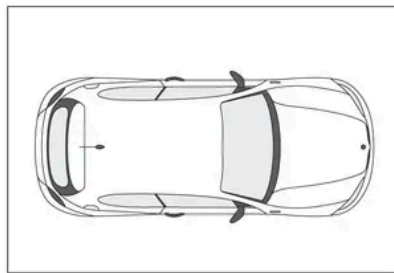

BASEMENT PARKING



PLANS SHOWN ONLY INDICATIVE OF LAYOUT, DIMENSIONS ARE APPROXIMATE.
Ref. No:



114/13 WAINE STREET

SURRY HILLS

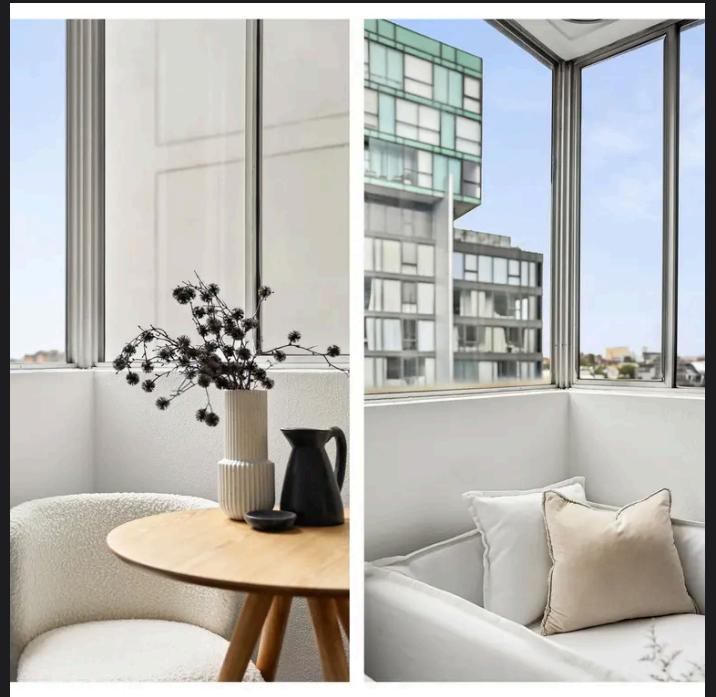

Dalton Stewart 0458 668 119
dalton.stewart@raywhite.com

Walter Burfitt-Williams 0402 833 566
walter.bw@raywhite.com

Disclaimer: All information provided is sourced from what we believe to be reliable sources. However, we do not guarantee its accuracy, and interested parties should conduct their own enquiries. Scale in metres. Indicative only. Dimensions are approximate.