

RayWhite®

TOUMA TAYLOR



Character charm and ultra-convenience

12/31-33 Elizabeth Bay Road, Elizabeth Bay

1 bed 1 bath

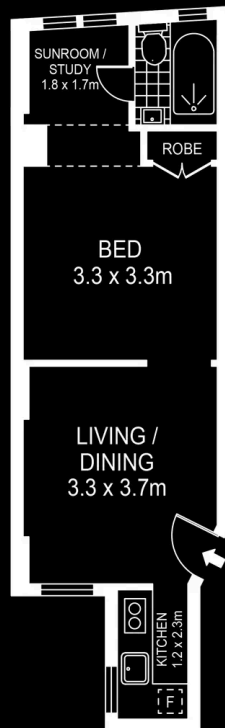

LEVEL TWO



Nickolas Voloshanskyi
nickolas.voloshanskyi@raywhite.com

Renee Cross 0413 764 566
renee.cross@raywhite.com

Disclaimer: All information provided is sourced from what we believe to be reliable sources. However, we do not guarantee its accuracy, and interested parties should conduct their own enquiries. Scale in metres. Indicative only. Dimensions are approximate.