

RayWhite®

TOUMA TAYLOR



**Timeless Family Home In Prestigious
Kensington Address**

13 Eastern Avenue, Kensington

5 bed 3 bath 2 car

Sold

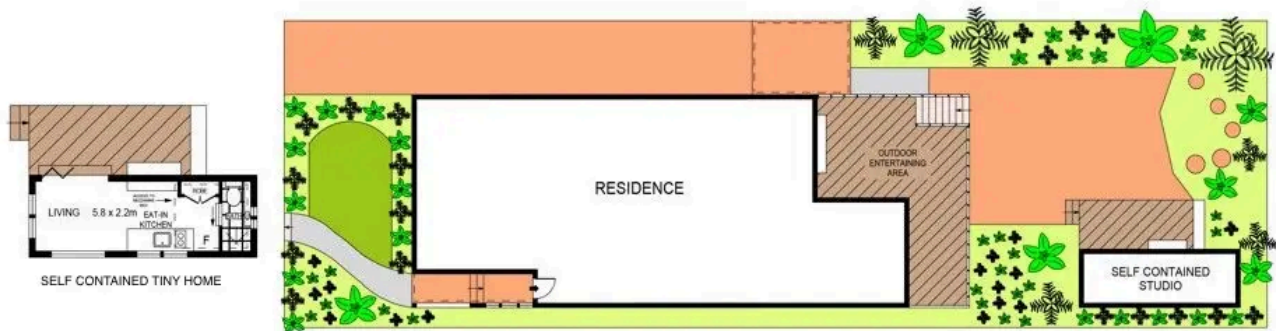

SITE PLAN
(NOT TO SCALE)



ENTRY LEVEL

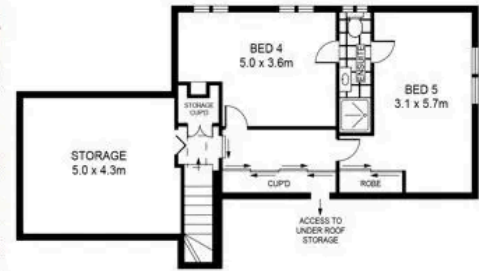

LEVEL ONE

SCALE (METRES)

PLANS SHOWN ONLY INDICATIVE OF LAYOUT. DIMENSIONS ARE APPROXIMATE.
Ref. No: 05831



13 EASTERN AVENUE

KENSINGTON



Roger Wardy 0481 355 493
roger.wardy@raywhite.com

Jesse Petersen 0404197940
jesse.petersen@raywhite.com

Disclaimer: All information provided is sourced from what we believe to be reliable sources. However, we do not guarantee its accuracy, and interested parties should conduct their own enquiries. Scale in metres. Indicative only. Dimensions are approximate.