

# RayWhite®

TOUMA TAYLOR



**Position-perfect in a tree lined street**

13/122-130 Arthur Street, Surry Hills

1 bed 1 bath 1 car

**Sold**

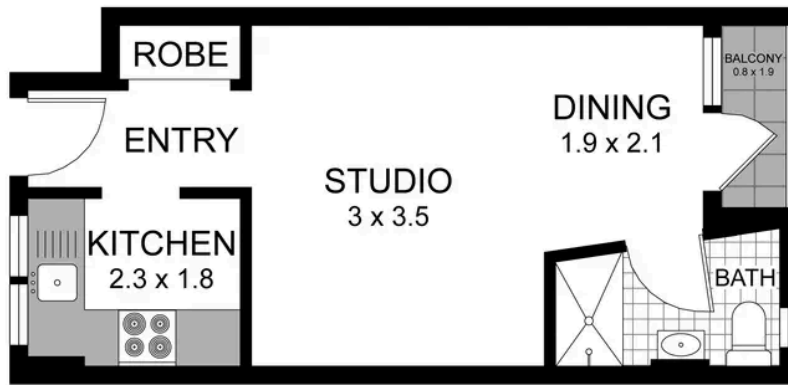

**LEVEL  
TWO**

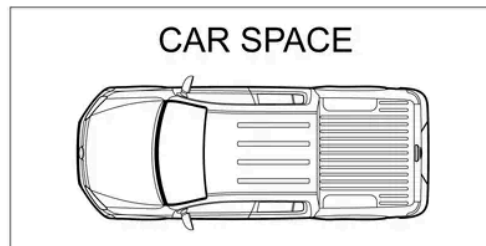

**GROUND  
LEVEL**

0 1 2 3 4



13/122-130 ARTHUR STREET  
SURRY HILLS

**RAY WHITE TAYLOR & PARTNERS**

**1 Bath, 1 Car**

Internal area (approx.) 25sqm  
Total area (approx.) 39sqm



PLEASE NOTE: WHILST RAY WHITE TAKES EVERY CARE IN THE PURSUIT OF ACCURACY, THE PLAN IS SHOWN FOR GENERAL GUIDANCE ONLY. ALL AREAS, MEASUREMENTS AND DISTANCES ARE APPROXIMATE AND NOT TO SCALE. RAY WHITE AND OUR VENDOR WILL ACCEPT NO RESPONSIBILITY FOR ITS ACCURACY. INTERESTED PARTIES ARE ADVISED TO MAKE THEIR OWN INDEPENDENT ENQUIRIES.

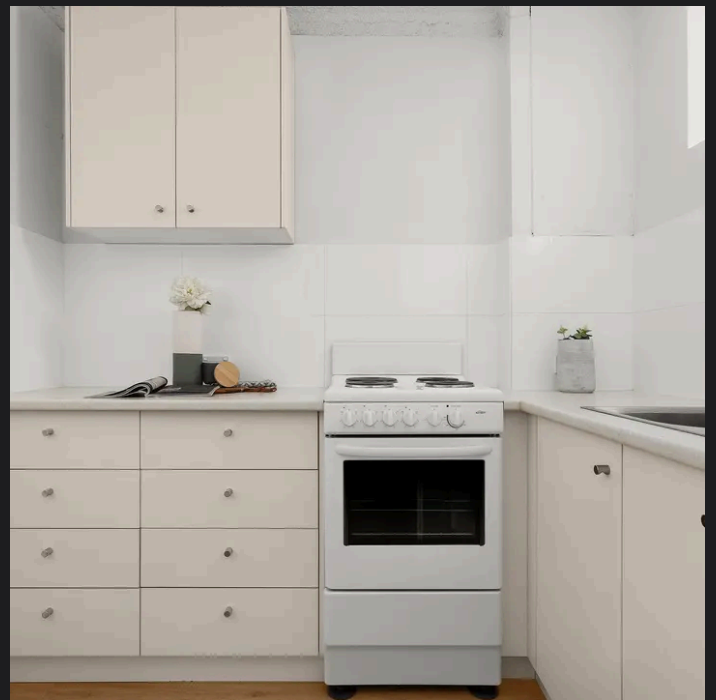

**Disclaimer:** All information provided is sourced from what we believe to be reliable sources. However, we do not guarantee its accuracy, and interested parties should conduct their own enquiries. Scale in metres. Indicative only. Dimensions are approximate.