

# **RayWhite®**

TOUMA TAYLOR



**Idyllic harbourside retreat in gracious  
c1930s 'Woodland'**

15/4 Waratah Street, Rushcutters Bay

1 bed 1 bath

**Sold**

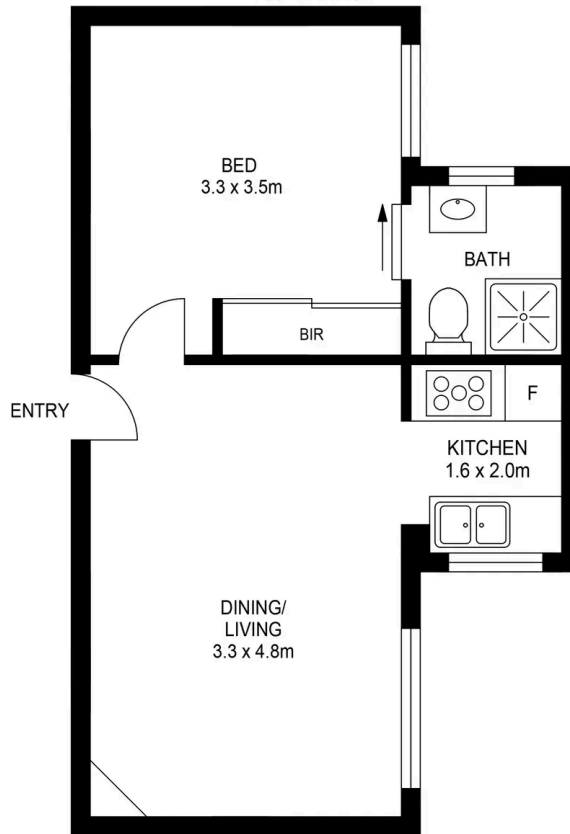

15/4 Waratah Street RUSHCUTTERS BAY

PLANS SHOWN ONLY INDICATIVE OF LAYOUT.  
DIMENSIONS ARE APPROXIMATE.



**Renee Cross 0413 764 566**  
renee.cross@raywhite.com

**Nickolas Voloshanskyi**  
nickolas.voloshanskyi@raywhite.com