

# ***RayWhite***<sup>®</sup>

TOUMA TAYLOR



**Marvelous 2021 Home of Space & Style**

16A George Street, Eastlakes

5 bed 3 bath 2 car

**Sold**

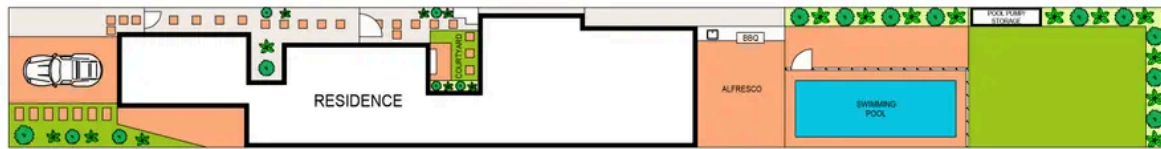

**SITE PLAN**  
(NOT TO SCALE)

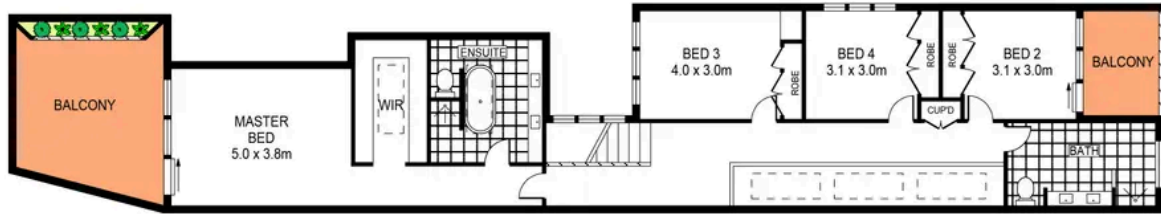

**LEVEL ONE**

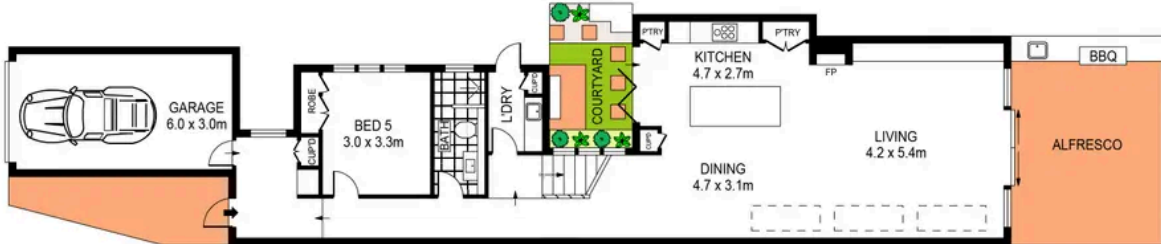

**GROUND LEVEL**

SCALE (METRES)

PLANS SHOWN ONLY INDICATIVE OF LAYOUT. DIMENSIONS ARE APPROXIMATE.  
Ref. No: 101145

APPROX. INTERNAL AREA : 296sqm (APPROX)



**16A GEORGE STREET**

**EASTLAKES**

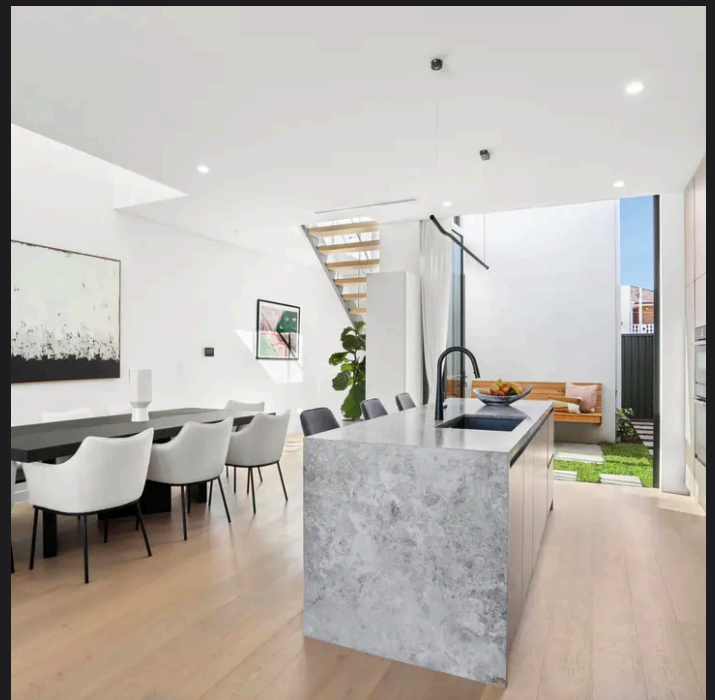

**Roger Wardy 0481 355 493**  
roger.wardy@raywhite.com

**Disclaimer:** All information provided is sourced from what we believe to be reliable sources. However, we do not guarantee its accuracy, and interested parties should conduct their own enquiries. Scale in metres. Indicative only. Dimensions are approximate.