

RayWhite®

TOUMA TAYLOR



**North facing Deco apartment in boutique
block**

1/8 Vialoux Avenue, Paddington

2 bed 1 bath

Sold

1/8 VIALOUX AVENUE
PADDINGTON

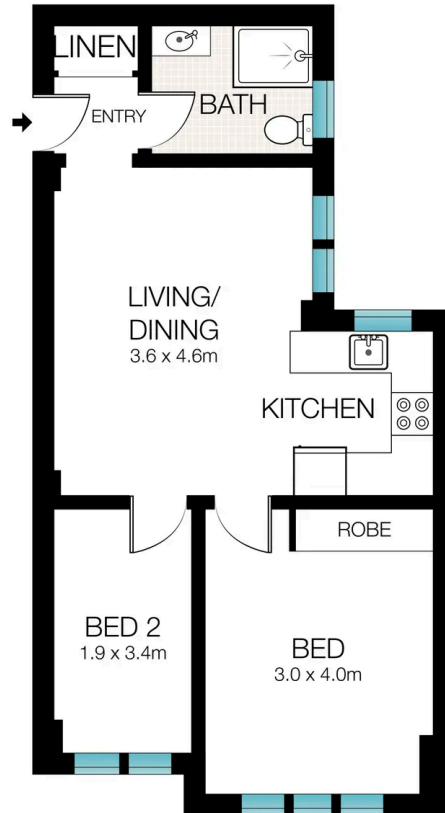

GROUND FLOOR

RAY WHITE TAYLORJONES

All information contained herein is gathered from sources we believe to be reliable. However, we cannot guarantee it's accuracy and interested persons should rely on their own enquiries. Dimensions are approximate.

Approximate Areas:	
Total:	43 sqm



Disclaimer: All information provided is sourced from what we believe to be reliable sources. However, we do not guarantee its accuracy, and interested parties should conduct their own enquiries. Scale in metres. Indicative only. Dimensions are approximate.