

RayWhite®

TOUMA TAYLOR



**Wonderfully Spacious Federation Semi
With Sweeping Golf Course Outlook**

19 Salisbury Road, Kensington

3 bed 1 bath

Sold

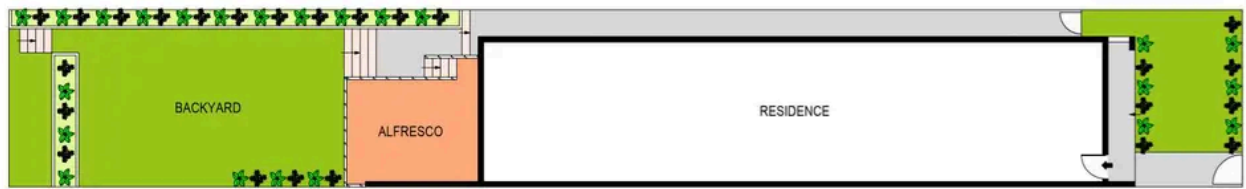

SITE PLAN
(NOT TO SCALE)



GROUND FLOOR



SCALE (METRES)

PLANS SHOWN ONLY INDICATIVE OF LAYOUT. DIMENSIONS ARE APPROXIMATE.
Ref. No: 108727



19 SALISBURY ROAD

KENSINGTON



Roger Wardy 0481 355 493
roger.wardy@raywhite.com

Disclaimer: All information provided is sourced from what we believe to be reliable sources. However, we do not guarantee its accuracy, and interested parties should conduct their own enquiries. Scale in metres. Indicative only. Dimensions are approximate.