

RayWhite®

TOUMA TAYLOR



**Penthouse-Inspired Apartment In
Unbeatable Lifestyle Precinct**

21/238 William Street, Potts Point

2 bed 2 bath

Sold



LEVEL SIX



PLANS SHOWN ONLY INDICATIVE OF LAYOUT. DIMENSIONS ARE APPROXIMATE.
Ref. No: 01451

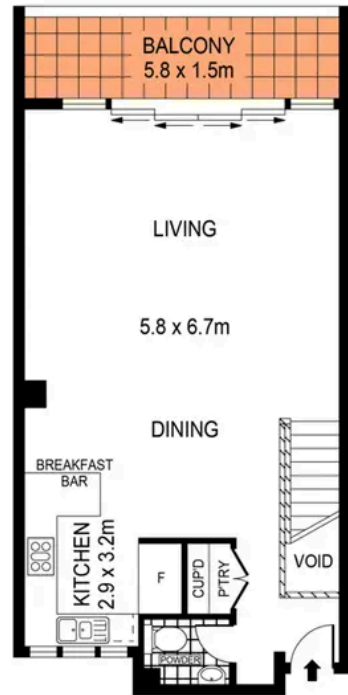

LEVEL SEVEN



21/238 WILLIAM STREET

POTTS POINT



Max Klimenko 0425 336 555
max.klimenko@raywhite.com

Charles Touma 0425 305 455
charles.touma@raywhite.com

Disclaimer: All information provided is sourced from what we believe to be reliable sources. However, we do not guarantee its accuracy, and interested parties should conduct their own enquiries. Scale in metres. Indicative only. Dimensions are approximate.