

RayWhite®

TOUMA TAYLOR



**Stylishly Appointed Terrace In Coveted
Tree-Lined Street**

22 Ivy Street, Darlington

3 bed 1 bath

Sold

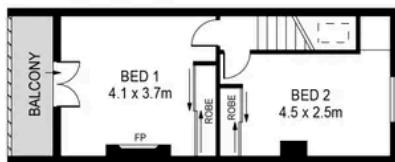

LEVEL ONE

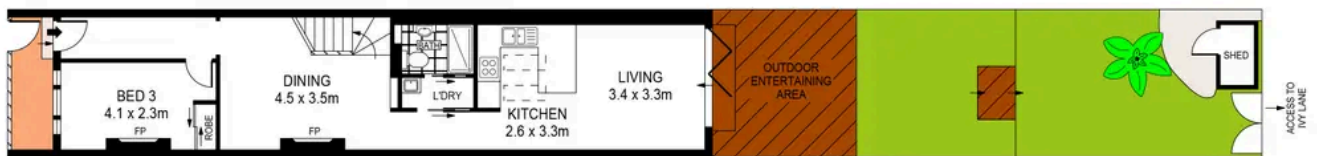

GROUND LEVEL



SCALE (METRES)

PLANS SHOWN ONLY INDICATIVE OF LAYOUT. DIMENSIONS ARE APPROXIMATE.
Ref. No. 86309



22 IVY STREET

DARLINGTON

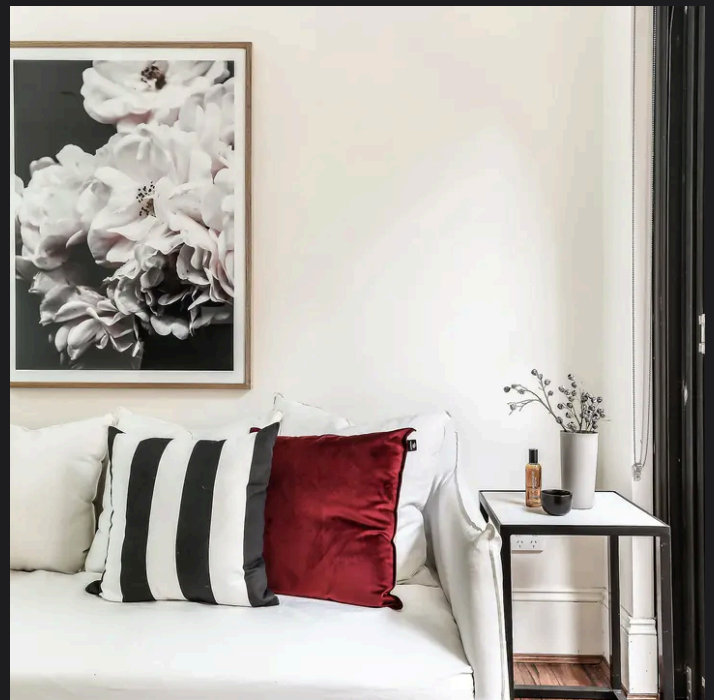

Charles Touma 0425 305 455
charles.touma@raywhite.com

Hayden Richards 0414 872 784
hayden.richards@raywhite.com

Disclaimer: All information provided is sourced from what we believe to be reliable sources. However, we do not guarantee its accuracy, and interested parties should conduct their own enquiries. Scale in metres. Indicative only. Dimensions are approximate.