

RayWhite®

TOUMA TAYLOR



**Sleek North Facing Courtyard Abode in
'The George'**

23/153 George Street, Redfern

2 bed 1 bath

Sold

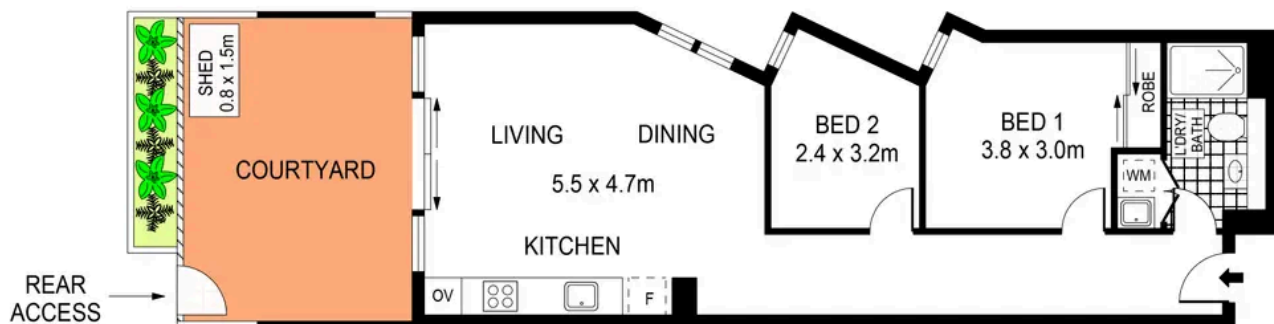

GROUND LEVEL

0 1 2 3 4 5 SCALE (METRES)

PLANS SHOWN ONLY INDICATIVE OF LAYOUT. DIMENSIONS ARE APPROXIMATE.
Ref. No: 05162



23/153 GEORGE STREET

REDFERN



Hayden Richards 0414 872 784
hayden.richards@raywhite.com

Disclaimer: All information provided is sourced from what we believe to be reliable sources. However, we do not guarantee its accuracy, and interested parties should conduct their own enquiries. Scale in metres. Indicative only. Dimensions are approximate.