

RayWhite®

TOUMA TAYLOR



**Brilliant North-Facing Home of Superior
Quality & Aesthetic**

24 Prospect Street, Surry Hills

2 bed 1 bath

Sold

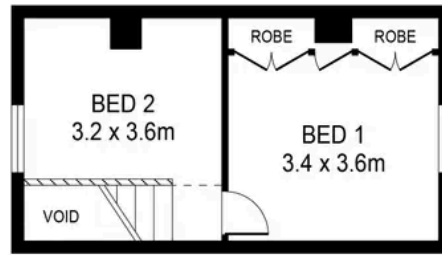

FIRST FLOOR

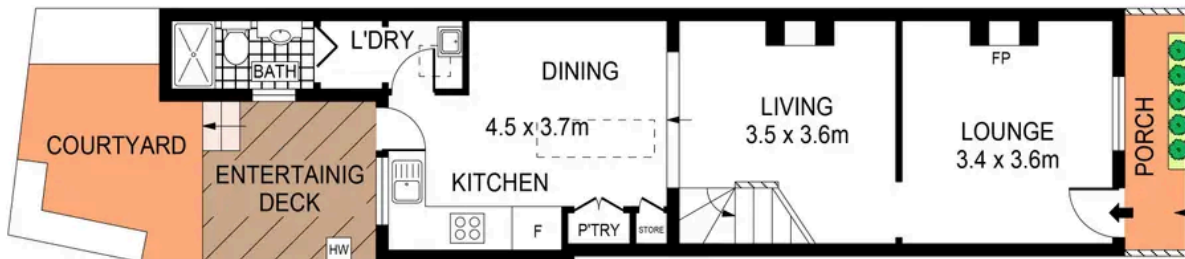

GROUND FLOOR



PLANS SHOWN ONLY INDICATIVE OF LAYOUT. DIMENSIONS ARE APPROXIMATE.
Ref. No: 100722



APPROX. INTERNAL AREA: 70m²
APPROX. EXTERNAL AREA: 21m²
TOTAL AREA (APPROX.): 91m²



24 PROSPECT STREET

SURRY HILLS



Charles Touma 0425 305 455
charles.touma@raywhite.com

Hayden Richards 0414 872 784
hayden.richards@raywhite.com

Disclaimer: All information provided is sourced from what we believe to be reliable sources. However, we do not guarantee its accuracy, and interested parties should conduct their own enquiries. Scale in metres. Indicative only. Dimensions are approximate.