

RayWhite®

TOUMA TAYLOR



**Quintessential Family Home With Desirable
North Facing Backyard**

25 Cowper Avenue, Pagewood

5 bed 4 bath 3 car

Sold



GROUND FLOOR

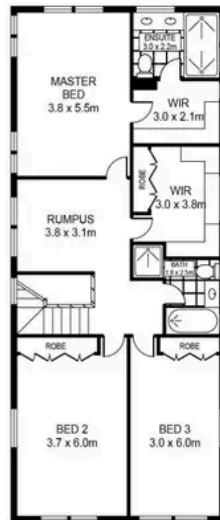

FIRST FLOOR

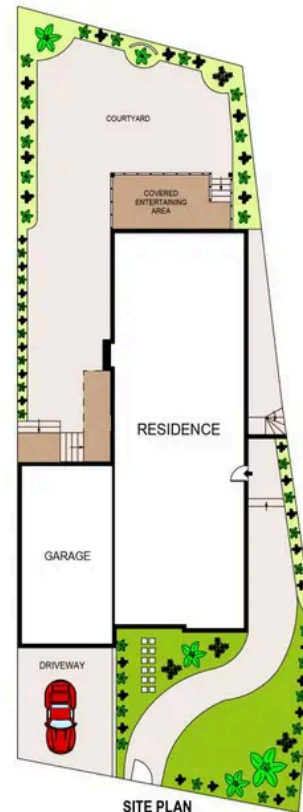

SITE PLAN
(NOT TO SCALE)

APPROX. INTERNAL AREA: 250m²
TOTAL LAND SIZE: 519m²



SCALE (METRES)

PLANS SHOWN ONLY INDICATIVE OF LAYOUT. DIMENSIONS ARE APPROXIMATE.
Ref. No: 108842

25 COWPER AVENUE

PAGEWOOD

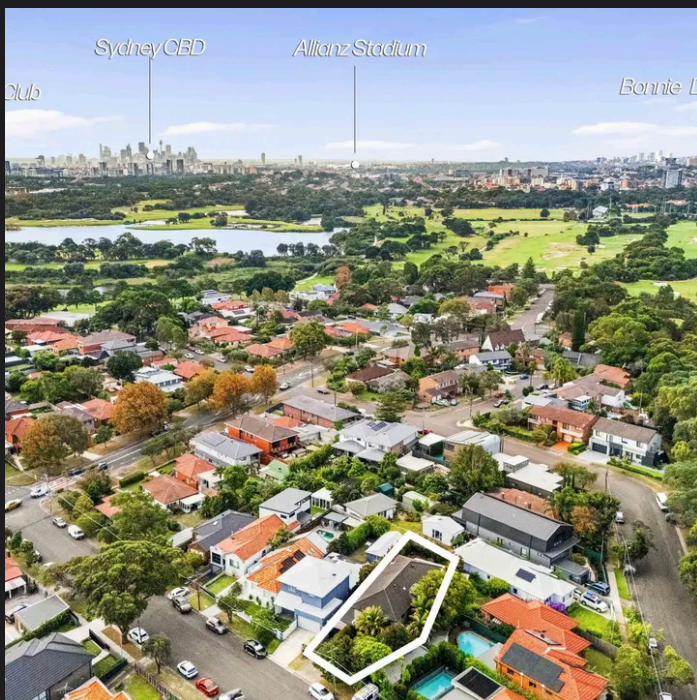

Roger Wardy 0481 355 493
roger.wardy@raywhite.com

Disclaimer: All information provided is sourced from what we believe to be reliable sources. However, we do not guarantee its accuracy, and interested parties should conduct their own enquiries. Scale in metres. Indicative only. Dimensions are approximate.