

RayWhite®

TOUMA TAYLOR



**Classic Terrace with DA Approval for 3
Bedroom Home**

33 Phelps Street, Surry Hills

2 bed 1 bath

Sold

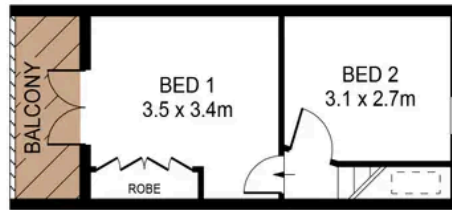

LEVEL ONE

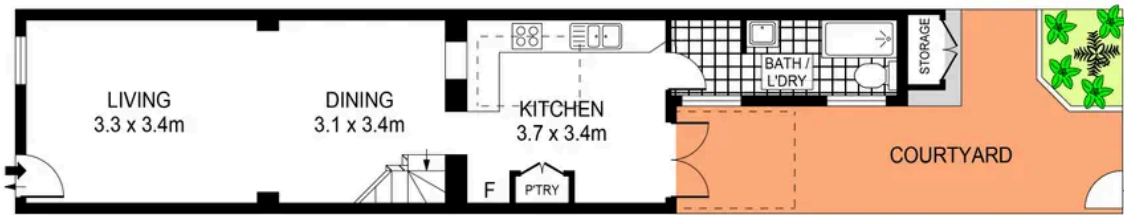

ENTRY LEVEL



PLANS SHOWN ONLY INDICATIVE OF LAYOUT. DIMENSIONS ARE APPROXIMATE.
Ref. No: 107384



33 PHELPS STREET

SURRY HILLS



Charles Tuma 0425 305 455
charles.tuma@raywhite.com

Cadan Hickey 0404 206 240
cadan_hickey@raywhite.com

Disclaimer: All information provided is sourced from what we believe to be reliable sources. However, we do not guarantee its accuracy, and interested parties should conduct their own enquiries. Scale in metres. Indicative only. Dimensions are approximate.