

RayWhite®

TOUMA TAYLOR



**Ultra-Convenient Lifestyle Apartment in
'The Mark'**

413/18 Park Lane, Chippendale

1 bed 1 bath

Sold

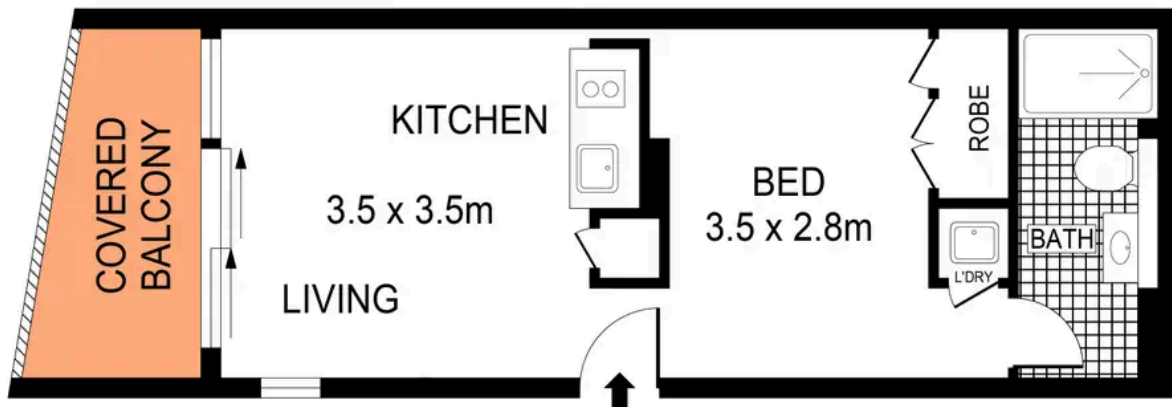

LEVEL FOUR

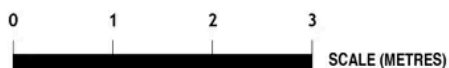

PLANS SHOWN ONLY INDICATIVE OF LAYOUT. DIMENSIONS ARE APPROXIMATE.
Ref. No: 88559



413/18 PARK LANE

CHIPPENDALE



Max Klimenko 0425 336 555
max.klimenko@raywhite.com

Disclaimer: All information provided is sourced from what we believe to be reliable sources. However, we do not guarantee its accuracy, and interested parties should conduct their own enquiries. Scale in metres. Indicative only. Dimensions are approximate.