

RayWhite®

TOUMA TAYLOR



**Sold Off-Market - Wide North Facing
Terrace With Elevated Entertaining Deck**

42 Phillip Street, Redfern

2 bed 1 bath

Sold

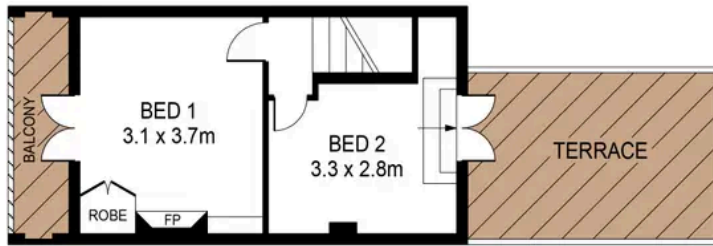

FIRST FLOOR



GROUND FLOOR



PLANS SHOWN ONLY INDICATIVE OF LAYOUT. DIMENSIONS ARE APPROXIMATE.
Ref. No: 98775



Land : 73sqm

42 PHILLIP STREET

REDFERN



Charles Touma 0425 305 455
charles.touma@raywhite.com

Hayden Richards 0414 872 784
hayden.richards@raywhite.com

Disclaimer: All information provided is sourced from what we believe to be reliable sources. However, we do not guarantee its accuracy, and interested parties should conduct their own enquiries. Scale in metres. Indicative only. Dimensions are approximate.