

RayWhite®

TOUMA TAYLOR



**Tightly Held Home Located in the Heart of
Surry Hills**

43 Lansdowne Street, Surry Hills

3 bed 1 bath

Sold

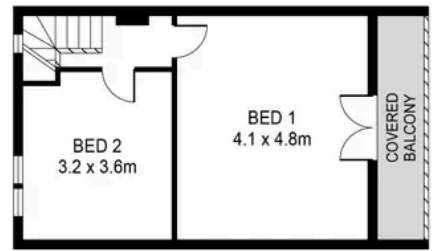

UPPER FLOOR



GROUND FLOOR



PLANS SHOWN ONLY INDICATIVE OF LAYOUT. DIMENSIONS ARE APPROXIMATE.
Ref. No: 106161



Approx Land Size: 127sqm

43 LANSDOWNE STREET

SURRY HILLS



Hayden Richards 0414 872 784
hayden.richards@raywhite.com

Charles Tuma 0425 305 455
charles.tuma@raywhite.com

Disclaimer: All information provided is sourced from what we believe to be reliable sources. However, we do not guarantee its accuracy, and interested parties should conduct their own enquiries. Scale in metres. Indicative only. Dimensions are approximate.