

RayWhite[®]

TOUMA TAYLOR



**Brand new renovated terrace in Newtown's
finest street**

54 Holmwood Street, Newtown

3 bed 2 bath 1 car

Sold

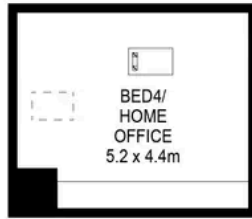

ATTIC



FIRST FLOOR

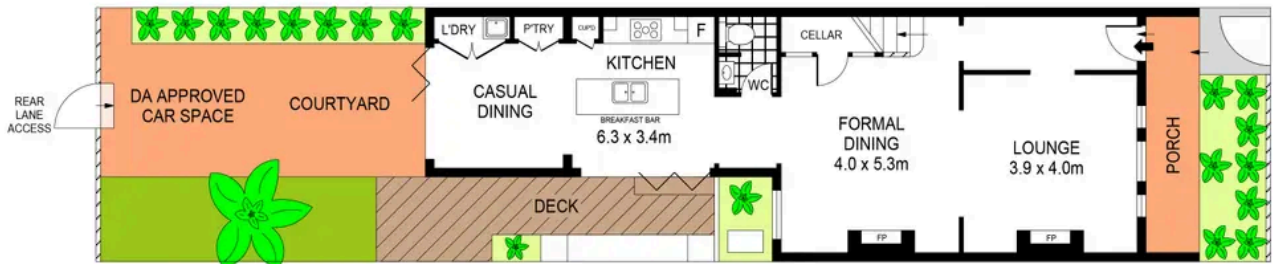

GROUND FLOOR

0 1 2 3 4 5
SCALE (METRES)

PLANS SHOWN ONLY INDICATIVE OF LAYOUT. DIMENSIONS ARE APPROXIMATE.
Ref. No: 93567



INT : 151SQM
LAND : 1465SQM



54 HOLMWOOD STREET

NEWTOWN



Charles Touma 0425 305 455
charles.touma@raywhite.com

Hayden Richards 0414 872 784
hayden.richards@raywhite.com

Disclaimer: All information provided is sourced from what we believe to be reliable sources. However, we do not guarantee its accuracy, and interested parties should conduct their own enquiries. Scale in metres. Indicative only. Dimensions are approximate.