

RayWhite®

TOUMA TAYLOR



**Charming Character Filled Terrace In
Historic Urban Pocket**

69 Caroline Street, Redfern

2 bed 1 bath

Sold

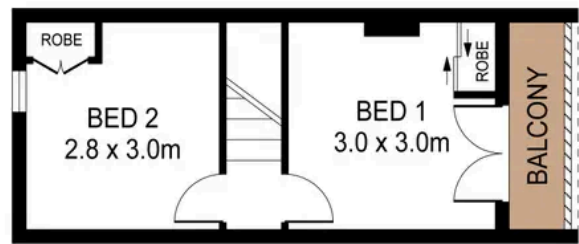

FIRST FLOOR

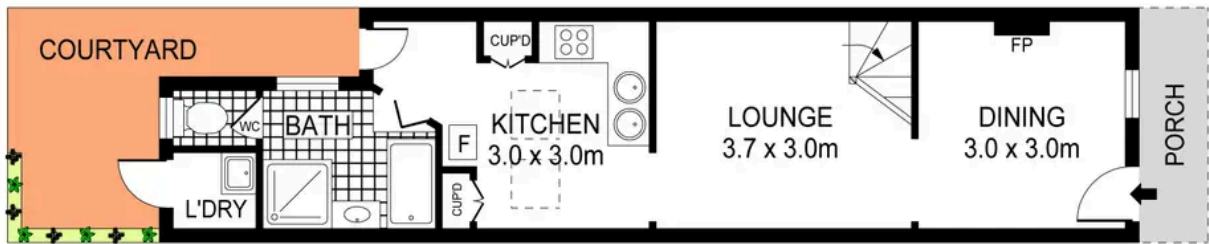

GROUND FLOOR



PLANS SHOWN ONLY INDICATIVE OF LAYOUT. DIMENSIONS ARE APPROXIMATE.
Ref. No: 104189



APPROX. TOTAL SPACE: 75m²



69 CAROLINE STREET

REDFERN



Charles Touma 0425 305 455
charles.touma@raywhite.com

Hayden Richards 0414 872 784
hayden.richards@raywhite.com

Disclaimer: All information provided is sourced from what we believe to be reliable sources. However, we do not guarantee its accuracy, and interested parties should conduct their own enquiries. Scale in metres. Indicative only. Dimensions are approximate.