

# RayWhite®

TOUMA TAYLOR



**North Facing Split-Level Abode with  
Uninterrupted Urban Views**

705/68 McEvoy Street, Alexandria

2 bed 1 bath 1 car

**Sold**

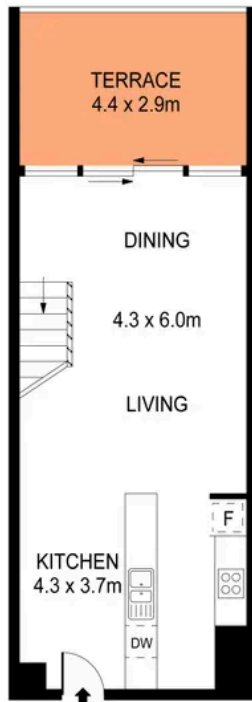

**LOWER FLOOR  
LEVEL SEVEN**



**UPPER FLOOR  
LEVEL SEVEN**

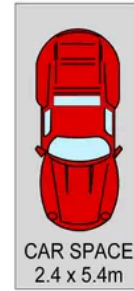

0 1 2 3 4 5  
SCALE (METRES)

PLANS SHOWN ONLY INDICATIVE OF LAYOUT. DIMENSIONS ARE APPROXIMATE.  
Ref. No: 01531

APPROX. TOTAL AREA : 106m<sup>2</sup>



705/68 MCEVOY STREET

ALEXANDRIA

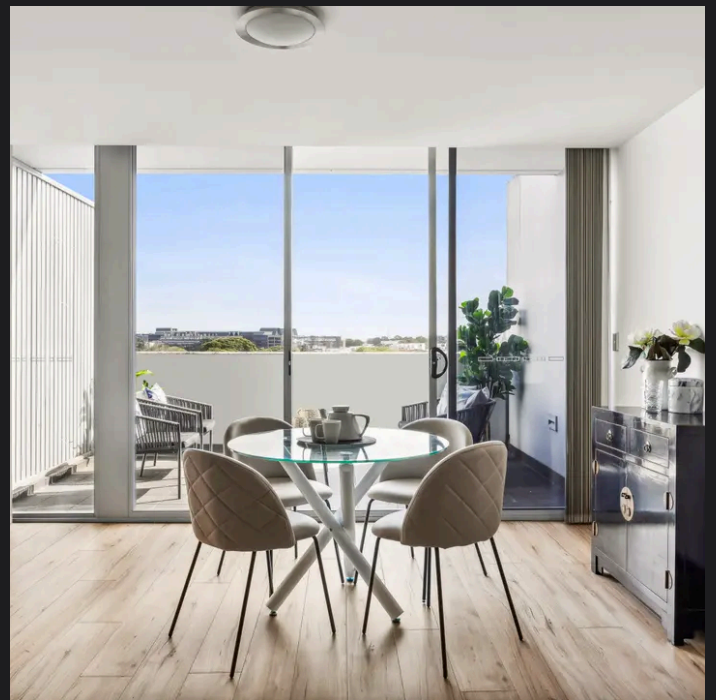

**Hayden Richards 0414 872 784**  
hayden.richards@raywhite.com

**Disclaimer:** All information provided is sourced from what we believe to be reliable sources. However, we do not guarantee its accuracy, and interested parties should conduct their own enquiries. Scale in metres. Indicative only. Dimensions are approximate.