

RayWhite®

TOUMA TAYLOR



Vibrant City Edge Living with Great Views

707/7-9 Gibbons Street, Redfern

1 bed 1 bath 1 car

Sold

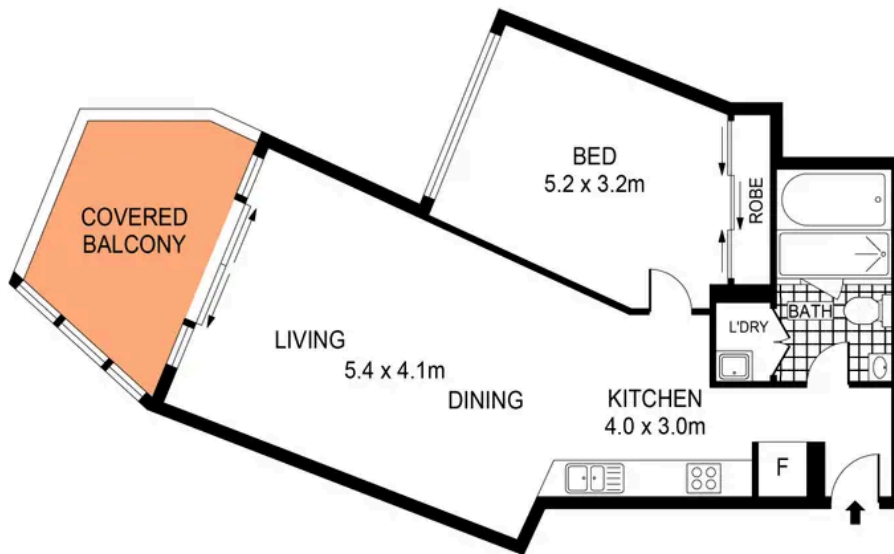

LEVEL SEVEN



BASEMENT



707/7-9 GIBBONS STREET

REDFERN

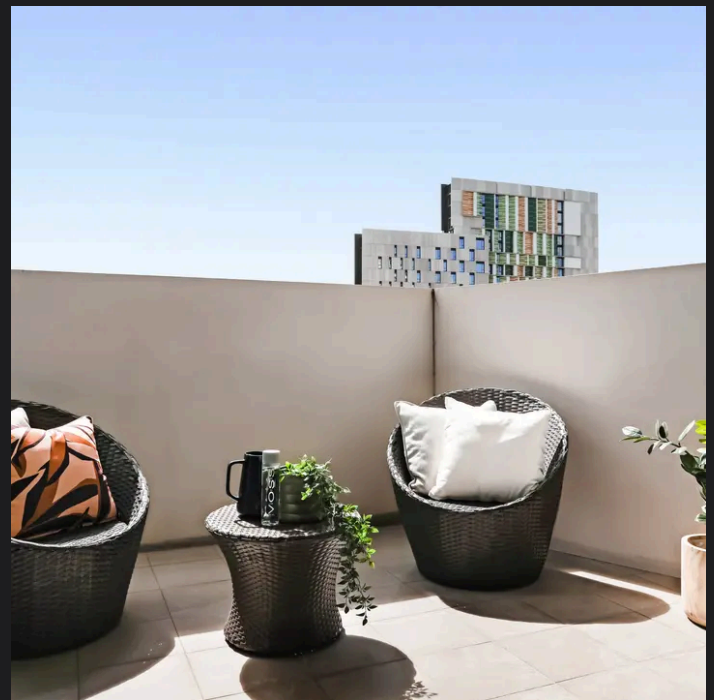

Max Klimenko 0425 336 555
max.klimenko@raywhite.com

Disclaimer: All information provided is sourced from what we believe to be reliable sources. However, we do not guarantee its accuracy, and interested parties should conduct their own enquiries. Scale in metres. Indicative only. Dimensions are approximate.