

RayWhite®

TOUMA TAYLOR



Ground Floor Retreat of Luxury and Space

G04/5 O'Dea Avenue, Zetland

1 bed 1 bath

Sold

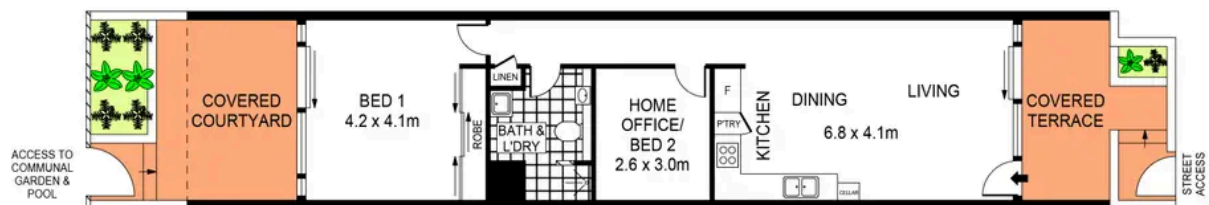

GROUND LEVEL

0 1 2 3 4 5
SCALE (METRES)

PLANS SHOWN ONLY INDICATIVE OF LAYOUT. DIMENSIONS ARE APPROXIMATE.
Ref. No: 95728



G04/5 O'DEA AVENUE

ZETLAND



Max Klimenko 0425 336 555
max.klimenko@raywhite.com

Disclaimer: All information provided is sourced from what we believe to be reliable sources. However, we do not guarantee its accuracy, and interested parties should conduct their own enquiries. Scale in metres. Indicative only. Dimensions are approximate.