

RayWhite®

TOUMA TAYLOR



**Unfurnished 2 Bedroom Split Level
Apartment**

1405/174 Goulburn Street, Surry Hills

2 bed 2 bath 1 car

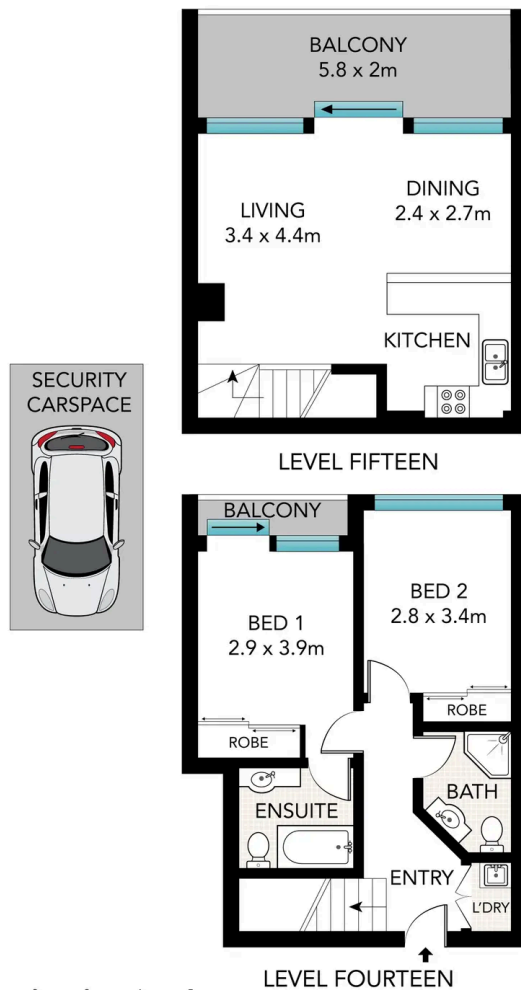

0 1 2 3 4 5

Scale in metres. Indicative only. Dimensions are approximate. All information contained herein is gathered from sources we believe to be reliable. However, we cannot guarantee its accuracy and interested persons should rely on their own enquiries.

1405/174 Goulburn Street, Surry Hills



Ray White.

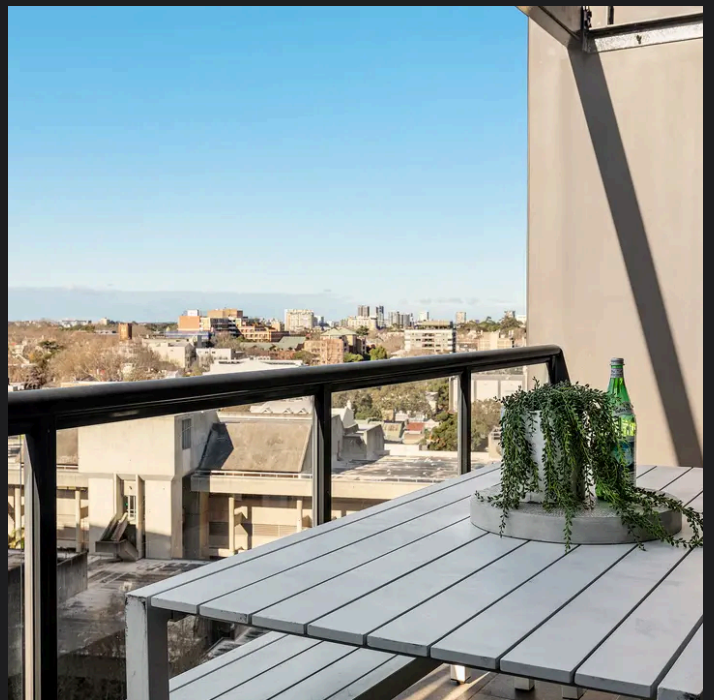

Bianca Walton 0478 579 468
bianca.walton@raywhite.com

Anastasia Dean (02) 9043 8777
anastasia.dean@raywhite.com

Disclaimer: All information provided is sourced from what we believe to be reliable sources. However, we do not guarantee its accuracy, and interested parties should conduct their own enquiries. Scale in metres. Indicative only. Dimensions are approximate.