

RayWhite[®]

TOUMA TAYLOR



Architect Designed Apartment with North-East Aspect & Leafy Park Views - Offered Furnished or Unfurnished

18/50-58 Roslyn Gardens, Rushcutters Bay

1 bed 1 bath 2 car

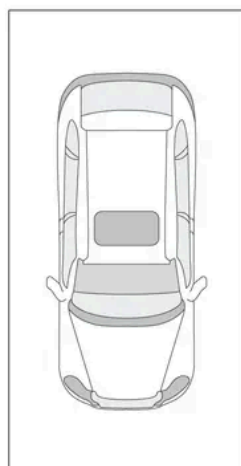

SCRAMBLE
PARKING

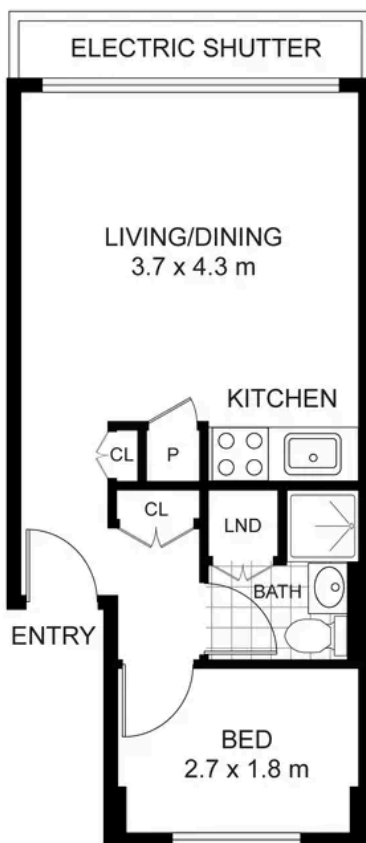

0 1 2 3 4 5
SCALE (METRES)

PLANS SHOWN ONLY INDICATIVE OF LAYOUT, DIMENSIONS ARE APPROXIMATE.
Ref. No:



18/50 ROSLYN GARDENS

RUSHCUTTERS BAY



Heidi Gouverneur 0480 683 371
heidi.gouverneur@raywhite.com

Peter Taylor 0402 273 649
peter.taylor@raywhite.com

Disclaimer: All information provided is sourced from what we believe to be reliable sources. However, we do not guarantee its accuracy, and interested parties should conduct their own enquiries. Scale in metres. Indicative only. Dimensions are approximate.